

Jamf Parent

Uppsetning smáforrits sem foreldrar geta notað
til að stjórna nemendaspjaldi frá eigin
tæki/síma utan skólatíma.

Sækja JamfParent app í App Store/Google Play

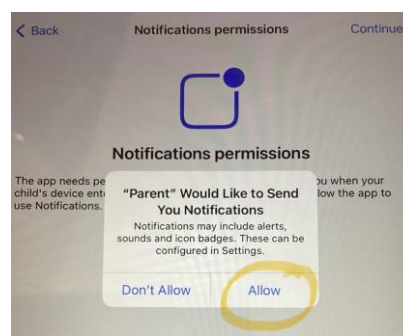

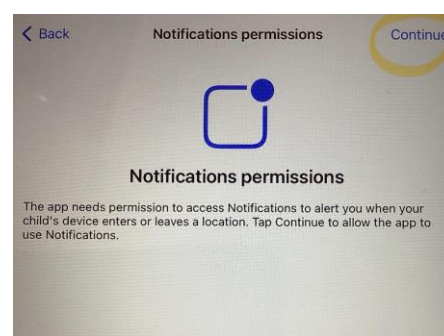
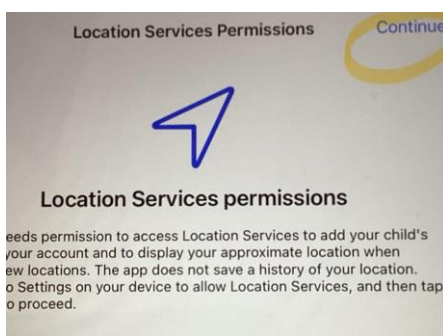
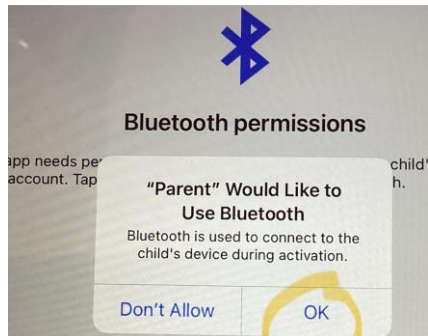
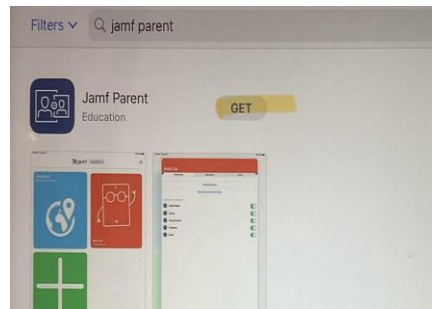
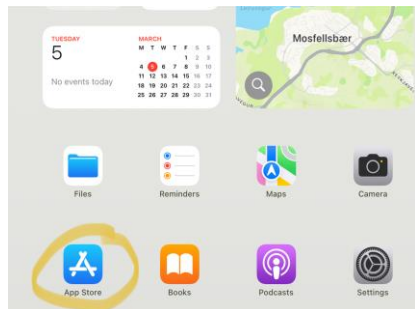
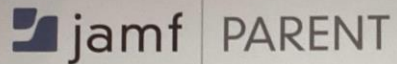

Use Jamf Parent to manage your
child's device.

Get started

[Privacy policy](#)

As required by Apple policy, we do not share any
data collected by our service with any third parties
for any reason.

- Þegar appið hefur verið sótt í tæki foreldris ætti þessi mynd að birtast
- Veljið 'Get started'
- Þá opnast gluggi til að skanna QR-kóða sem þarf að nálgast í tæki nemanda

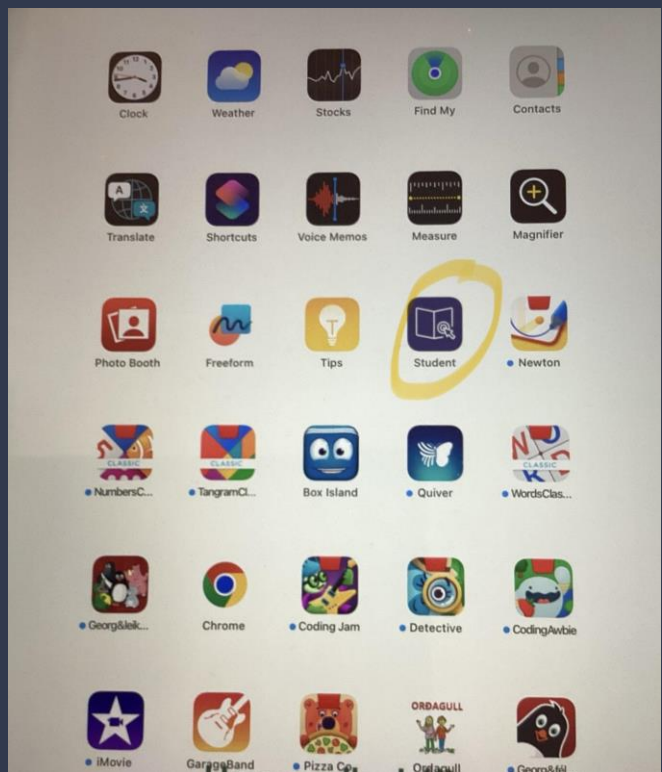

→ Opnið tæki nemanda og veljið Student appið

Að sækja QR-kóða í tæki nemandar

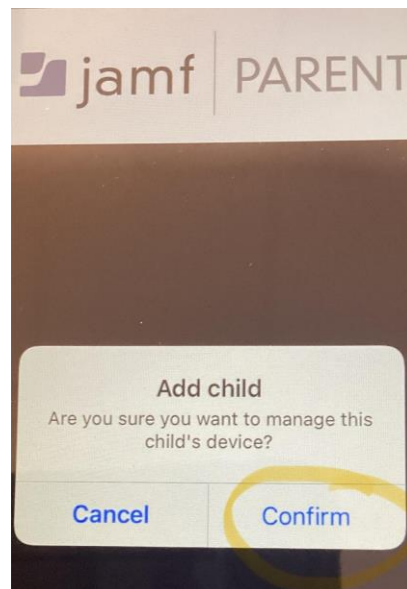
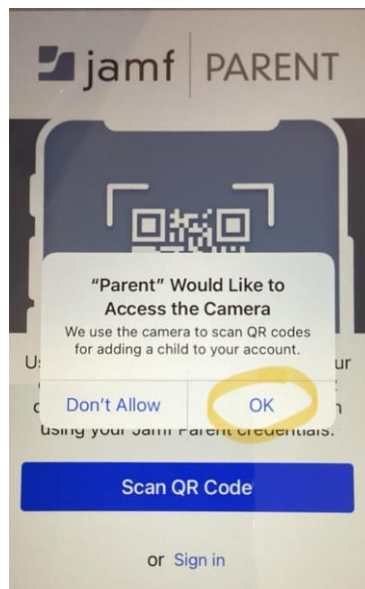
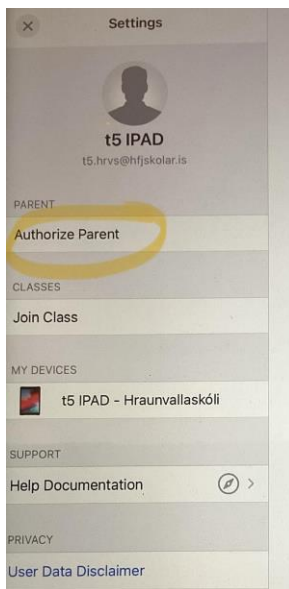
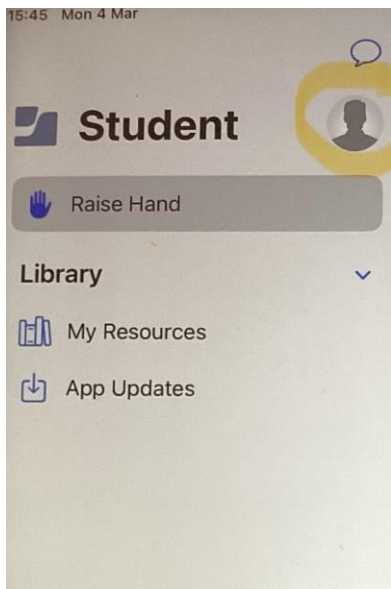
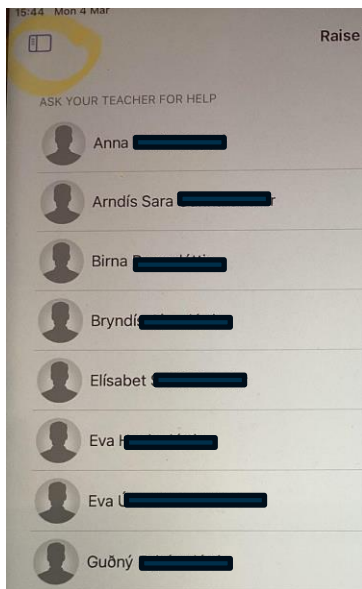

Látið ykkar tæki/síma lesa QR-kóðann í Student appinu og samþykkið að bæta barninu við. Hægt er að bæta fleiri nemendum við með því að velja Add child.